

**SITE MATERIAL LEGEND**

	APRON		GRAVEL
	SIDEWALK		LANDSCAPING
	LIGHT DUTY ASPHALT		HARD LANDSCAPING
	HEAVY DUTY ASPHALT		MULCH

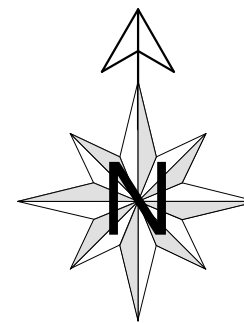
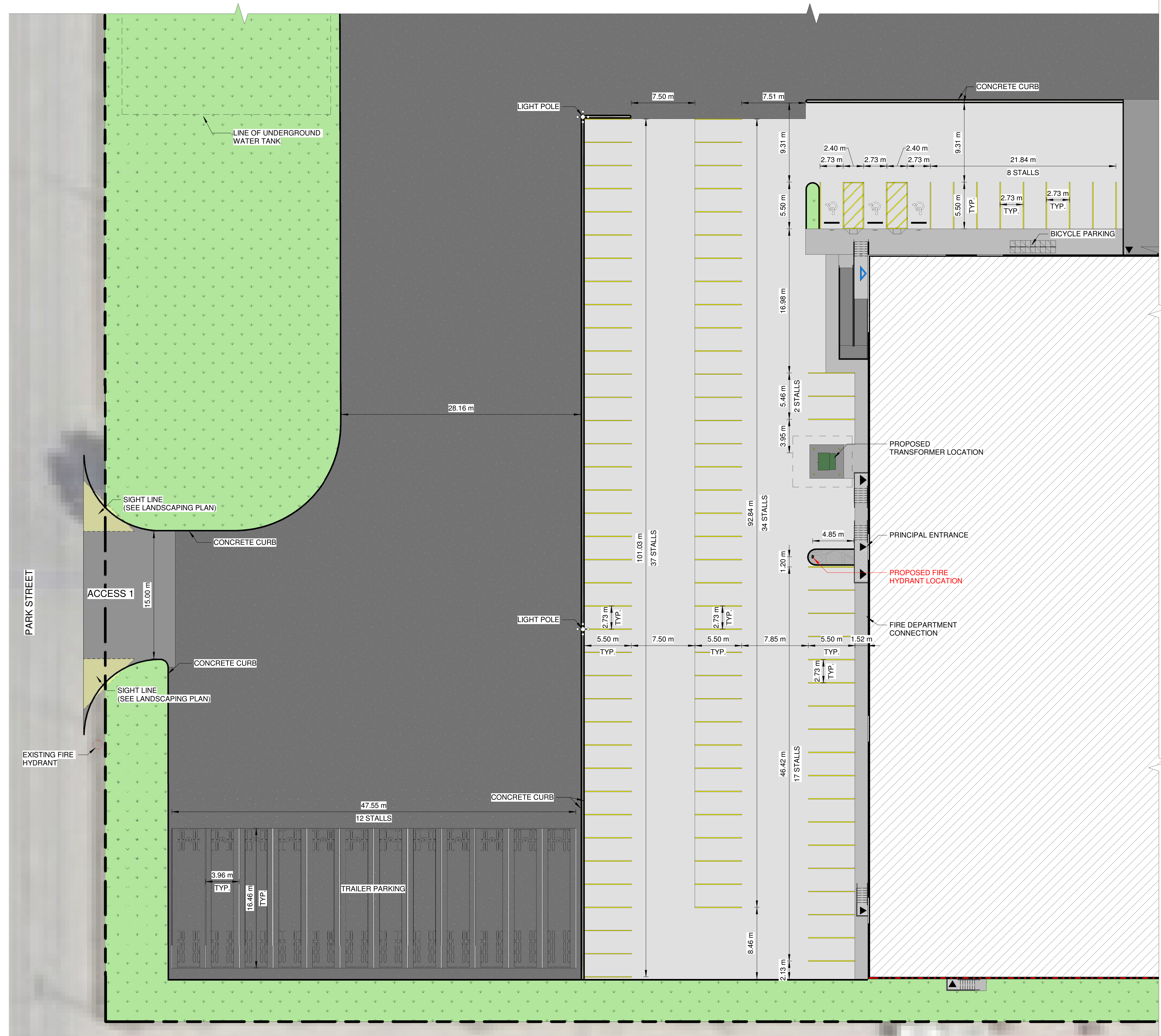

1 West Parking Plan (Enlarged)  
1:250

Architect:  
  
 Stamp:

aggregate  
design studio ltd.

(403) 885-5525 P.O. BOX 1690  
 BLACKFALDS, AB, T0M 0J0

Nexus REIT

**NEXUS**  
 Regina Warehouse  
 905 Park Street  
 Regina, Saskatchewan  
 Blk/Par. B, Plan 102245598

NO.	0
DESCRIPTION	ISSUED FOR CONSTRUCTION
DATE	2023-09-05

Project No: S22477  
 Date: 2023-09-05 9:44:33 AM  
 Drawn by: ER, AS, AK, EA  
 Checked by: JK  
 Sheet Name:

West Parking  
 Plan, Access 1  
 (Enlarged)

Sheet No:  
**A102**

DO NOT SCALE DRAWING - VERIFY ALL DIMENSIONS, DATUMS AND LEVELS PRIOR TO COMMENCEMENT OF WORK. REPORT ANY DISCREPANCIES OR OMISSIONS TO THE ARCHITECT IMMEDIATELY. ALL WORK MUST COMPLY WITH THE MOST RECENT EDITION OF THE APPLICABLE BUILDING CODE AND ANY OTHER GOVERNING AUTHORITIES. THIS IS A COPYRIGHT DRAWING AND SHALL NOT BE REPRODUCED OR REVISED WITHOUT THE WRITTEN CONSENT OF THE CONSULTANT.